

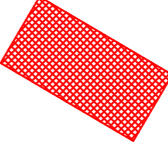

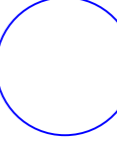

TREE CONSTRAINTS PLAN incl. LINK ROAD SHEET 1/2 - Northern Section of Site

LEGEND

-  Construction Exclusion Zone (CEZ)
-  Root Protection Extents
- 5080  Existing Tree
- 5079 (DEAD)  Existing Dead Tree
- 5062  Category U Tree (Remove)
-  Hedgerow of Trees

HARD SURFACES WITHIN THE CONSTRUCTION EXCLUSION ZONE (CEZ) - TYPICAL TREATMENT TO BE DETAILED BY ENGINEER

BS 5837 : 2012 TREES IN RELATION TO CONSTRUCTION.

Where hard surfaces are agreed within the CEZ a strict no dig design excavation must be adhered to, in the event where excavation is essential a hand dig system must be undertaken under arborist supervision. The hard surface to be permeable allowing the roots moisture infiltration and gaseous diffusion. The structure of the hard surface is to be designed to avoid localised compaction, by evenly distributing the carried weight. The sub base will consist of a three-dimensional cellular confinement system and the build up to the engineers detail and approved by the arborist.

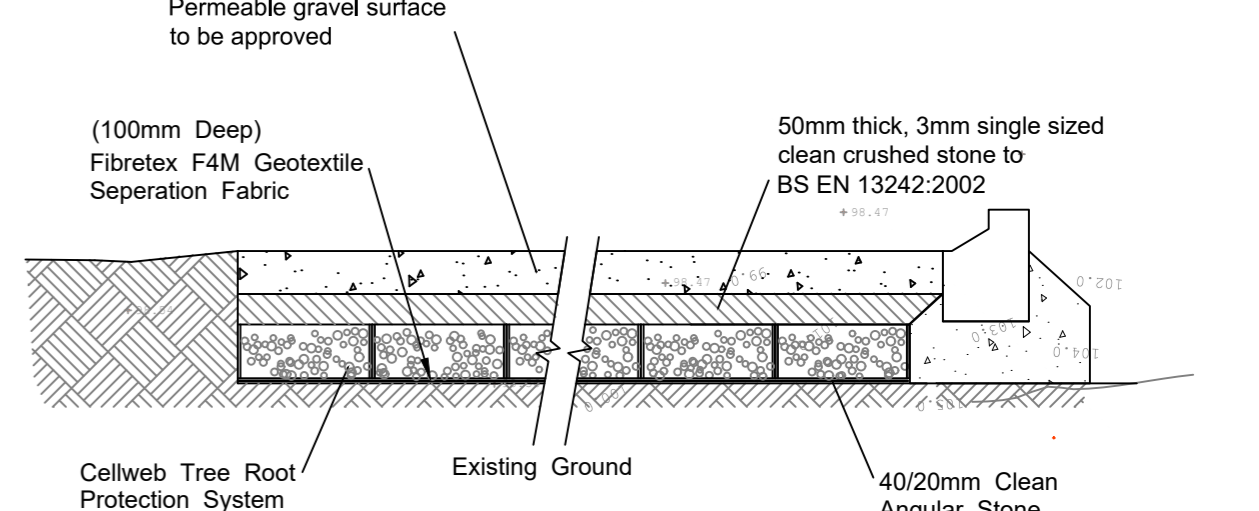

Overhanging Canopy Treatment

Tree Works to be carried out to **BS3998:2010** by a suitable qualified, insured and experienced Tree Surgeon

1. Remove Deadwood
2. Stack Deadwood at base of tree safely
3. Reduce Lower / Overhanging Limb lengths where overhanging the new Cycle path & Link Road
NB: With written Owner Permission

Boundary Treatment

Mounding of soil at the base of the boundary should be graded back sympathetically with Mechanical Excavator >12 tons under the supervision of the site appointed arborist.

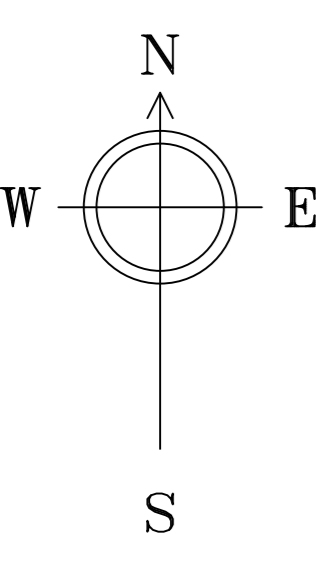
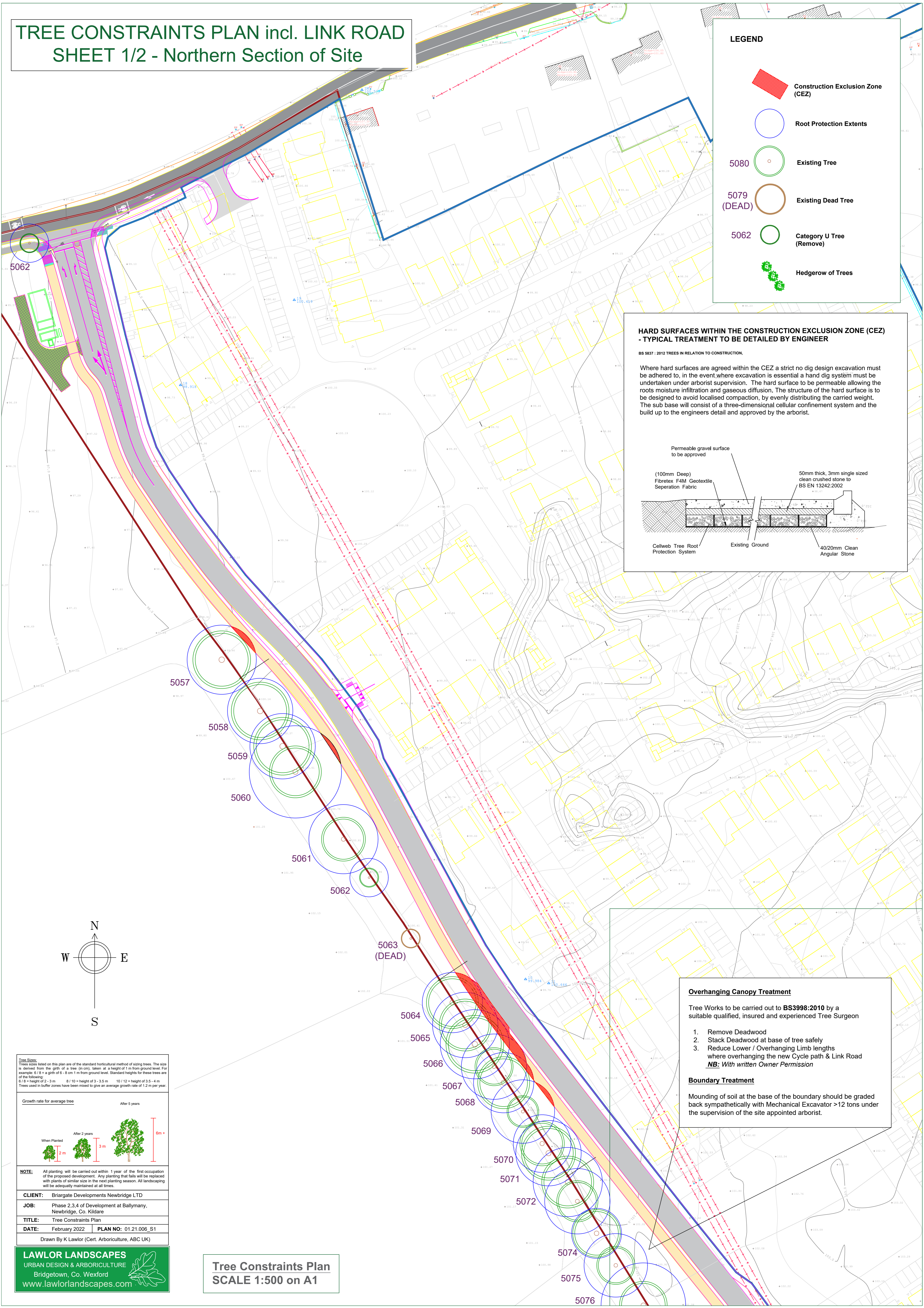

Tree Sizes:
Trees sizes listed on this plan are of the standard horizontal method of sizing trees. The size is derived from the girth of a tree (in cm), taken at a height of 1m from ground level. For example: 6/8 = a girth of 6 - 8 cm 1 m from ground level. Standard heights for these trees are of the following:
6/8 = height of 2 - 3 m 8/10 = height of 3 - 3.5 m 10/12 = height of 3.5 - 4 m
Trees used in buffer zones have been mixed to give an average growth rate of 1.2 m per year.

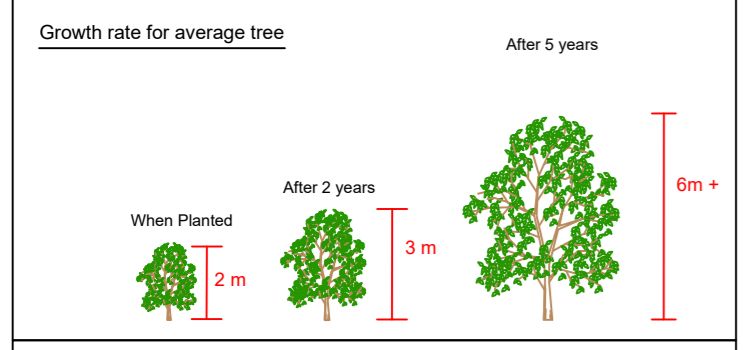

NOTE: All planting will be carried out within 1 year of the first occupation of the proposed development. Any planting that fails will be replaced with plants of similar size in the next planting season. All landscaping will be adequately maintained at all times.

CLIENT: Briargate Developments Newbridge LTD
JOB: Phase 2,3,4 of Development at Ballymany, Newbridge, Co. Kildare
TITLE: Tree Constraints Plan
DATE: February 2022 **PLAN NO:** 01.21.006_S1
Drawn By K Lawlor (Cert. Arboriculture, ABC UK)

LAWLOR LANDSCAPES
URBAN DESIGN & ARBORICULTURE
Bridgetown, Co. Wexford
www.lawlorlandscapes.com

Tree Constraints Plan
SCALE 1:500 on A1